

4

3

2

1

1.0 GENERAL NOTES

- 1.1 ALL METRIC DIMENSIONS ARE IN BRACKETS [X.X]
- 1.2 FEATURES CRITICAL TO QUALITY ARE INDICATED IN ROUNDED BOX (X.X)
- 1.3 3D DIGITAL FILES ARE FOR REFERENCE. IN CASE OF CONFLICT FOLLOW PDF DRAWING.
- 2.0 DESIGN NOTES
- 3.0 MANUFACTURING/SPECIAL REQUIREMENTS
 - 3.1 BREAK SHARP EDGES AND DEBURR PART FOR SAFE HANDLING
 - 3.2 GALVANIZE PER ASTM A123
 - 3.3 MARK WITH PART NUMBER, REVISION, AND VENDOR ID WITH ETCH, STAMP OR LABEL. CHARACTERS TO BE 0.12" TO 0.24" HIGH AND LEGIBLE TO THE UNAIDED EYE.
- 4.0 TEST
- 5.0 PACKAGING
 - 5.1 PACKAGING SHALL MEET COMMSCOPE REQUIREMENTS PER DOCUMENT IS-PL-3005

REVISIONS			
REV.	DESCRIPTION	DATE	APPROVED
A	INITIAL RELEASE	LS1146 25SEP23	BCROSS 40179845CMO

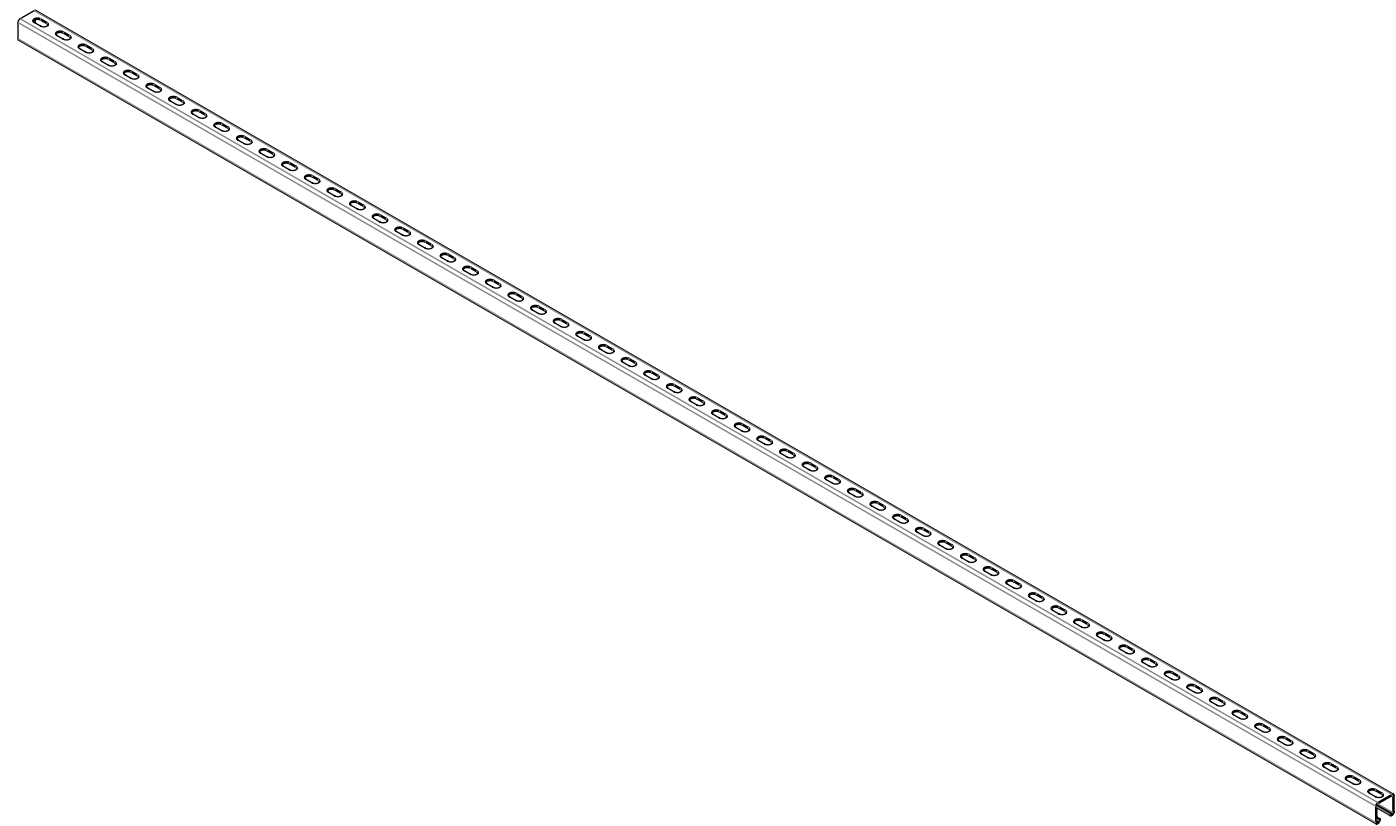
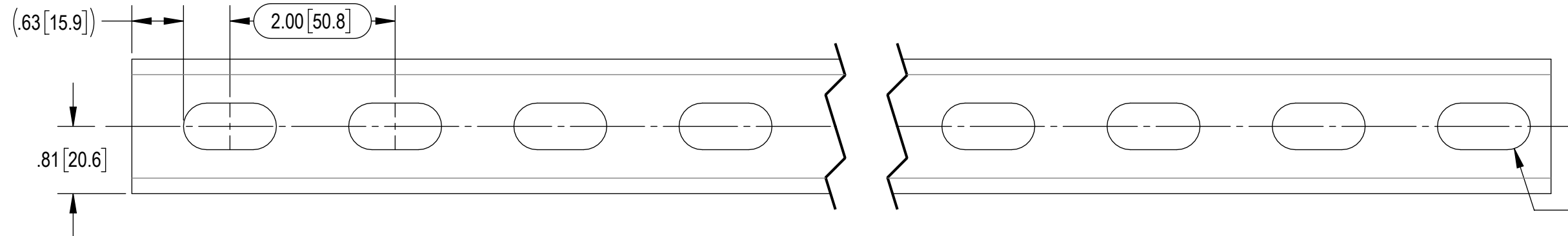
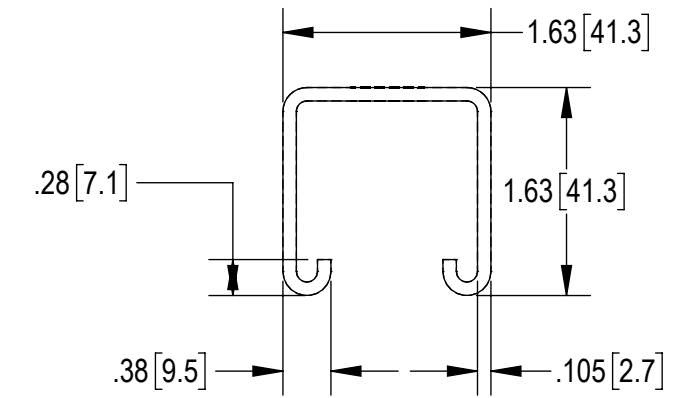
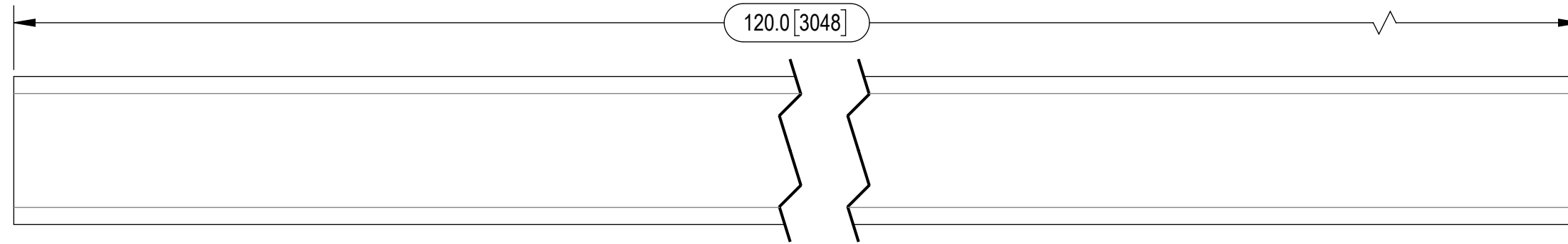

COMMSCOPE, INC. OF NORTH CAROLINA										
TOLERANCES					SAP MATERIAL MASTER					
1 PLACE .X[X] ± 0.06[1.5]			3 PLACE .XXX[X] ± 0.010[[0.3]		UNI-158-10-002					
2 PLACE .XX[X] ± 0.03[0.8]			ANGLES ± 2°							
FINISH PREGALVANIZED					MATERIAL STEEL, 12 GA					
UNLESS OTHERWISE SPECIFIED DIMENSIONS ARE IN INCHES INTERPRET PER ANSI Y 14.3M-1994	CE	LS1146	25SEP23	UNISTRUT, 1-5/8", 10'-LONG, SLOTS						
	RW	LS1146	09/26/2023							
	AD	BCROSS	09/26/2023							
	RE	LS1146	09/28/2023							
	ECN 40179845CMO									
SCALE 1:1.5		DOCUMENT NO. UNI-158-10-002								
SIZE	Auth Group	INSL	MODEL			DRAWING				SHEET 1 OF 1
C			VERSION	STATUS	REVISION	VERSION	STATUS	REVISION		
			00	IW	A	00	RE	A		

DENSITY	0.28	lbs/in³
MASS	17.65	lbs
VOLUME	62.08	in³
SURFACE AREA	1226.92	in²
HEIGHT	1.6"	
LENGTH	1.6"	
WIDTH	120"	

4

3

2

1