

# F2PDM-C

7-16 DIN Male for 3/8 in FSJ2-50 cable



**OBSOLETE**

This product was discontinued on: March 21, 2013

**Replaced By:**

F2TDF-PL	7-16 DIN Female Positive Lock for 3/8 in FSJ2-50 cable
F2TDM-PL	7-16 DIN Male Positive Lock for 3/8 in FSJ2-50 cable

## Product Classification

Product Type	Wireless and radiating connector
Product Brand	HELIAX®

## General Specifications

Body Style	Straight
Cable Family	FSJ2-50
Inner Contact Attachment Method	Captivated
Inner Contact Plating	Silver
Interface	7-16 DIN Male
Mounting Angle	Straight
Outer Contact Attachment Method	Self-clamping
Outer Contact Plating	Silver
Pressurizable	No

## Dimensions

Height	36.07 mm   1.42 in
Length	52.32 mm   2.06 in

# F2PDM-C

Diameter	36.07 mm   1.42 in
Nominal Size	3/8 in

## Outline Drawing

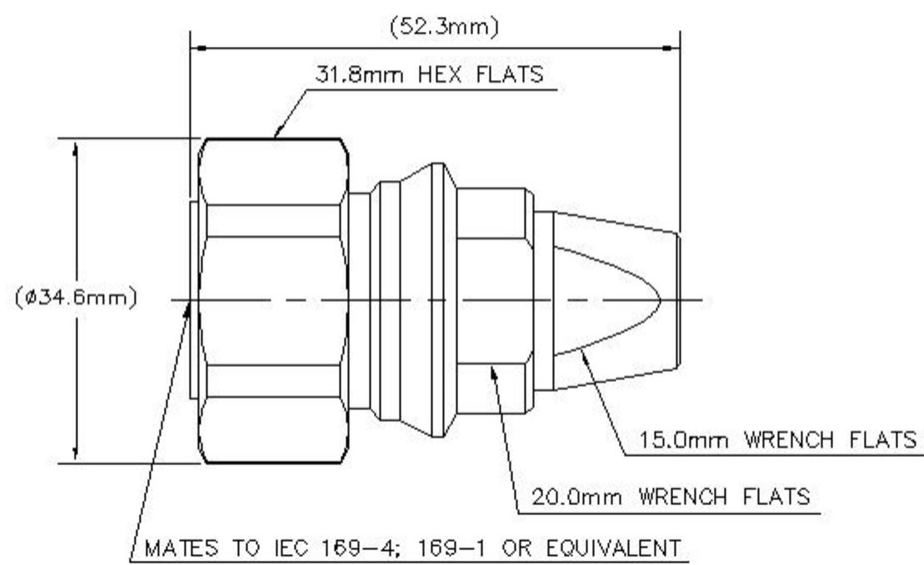

## Electrical Specifications

3rd Order IMD at Frequency	-112 dBm @ 910 MHz
3rd Order IMD Test Method	Two +43 dBm carriers
Average Power at Frequency	0.7 kW @ 900 MHz
Cable Impedance	50 ohm
Connector Impedance	50 ohm
dc Test Voltage	2300 V
Inner Contact Resistance, maximum	0.4 mOhm
Insulation Resistance, minimum	10000 MOhm
Operating Frequency Band	0 – 6000 MHz
Outer Contact Resistance, maximum	1.5 mOhm
Peak Power, maximum	13.2 kW
RF Operating Voltage, maximum (vrms)	813 V
Shielding Effectiveness	-110 dB

# F2PDM-C

## VSWR/Return Loss

Frequency Band	VSWR	Return Loss (dB)
45–2000 MHz	1.052	31.92

## Mechanical Specifications

Connector Retention Tensile Force	671.68 N   151 lbf
Connector Retention Torque	3.7 N-m   32.748 in lb
Coupling Nut Proof Torque	35 N-m   309.776 in lb
Coupling Nut Proof Torque Method	IEC 61169-16:9.3.11
Coupling Nut Retention Force	1000 N   224.81 lbf
Coupling Nut Retention Force Method	IEC 61169-17:9.3.11
Insertion Force	889.64 N   200 lbf
Insertion Force Method	IEC 61169-16:9.3.5
Interface Durability	500 cycles
Interface Durability Method	IEC 61169-4:17
Mechanical Shock Test Method	IEC 60068-2-27

## Environmental Specifications

Operating Temperature	-55 °C to +85 °C (-67 °F to +185 °F)
Storage Temperature	-65 °C to +125 °C (-85 °F to +257 °F)
Attenuation, Ambient Temperature	20 °C   68 °F
Average Power, Ambient Temperature	40 °C   104 °F
Average Power, Inner Conductor Temperature	100 °C   212 °F
Corrosion Test Method	IEC 60068-2-11
Immersion Depth	1 m
Immersion Test Mating	Mated
Immersion Test Method	IEC 60529:2001, IP68
Moisture Resistance Test Method	IEC 60068-2-3
Thermal Shock Test Method	IEC 60068-2-14
Vibration Test Method	IEC 60068-2-6

# F2PDM-C

---

## Packaging and Weights

**Weight, net** 123 g | 0.271 lb

### \* Footnotes

**Immersion Depth** Immersion at specified depth for 24 hours