

REVISIONS				
REV	DESCRIPTION	DATE	DWN	APV
AJ	ECN 800017777-REBRANDING	11-28-16	SC	JV

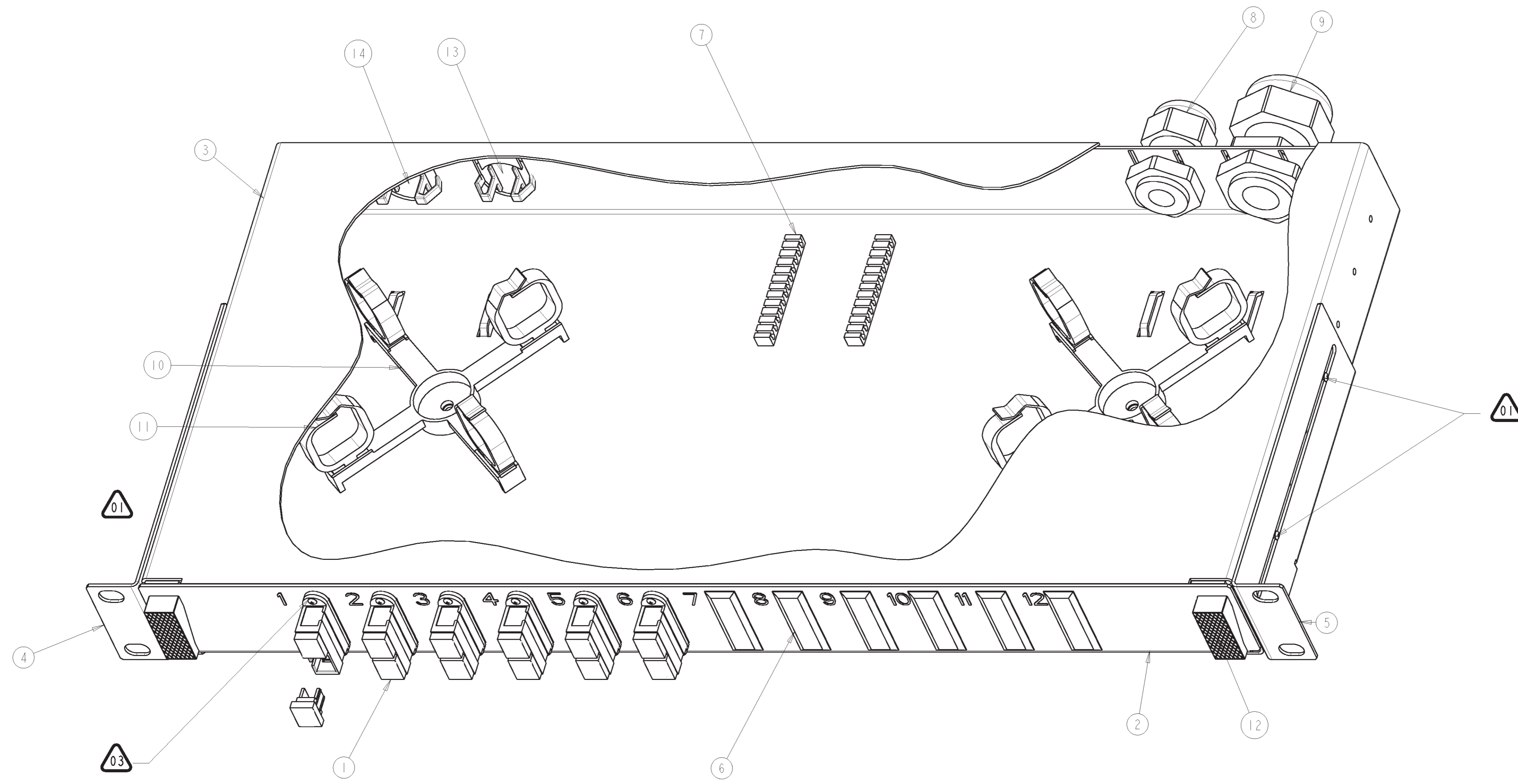

- 01** 4 SCREWS M3x5 TAPTITE POSI PAN ZINC PLATED INCLUDED WITH ENCLOSURE ASSY
- 02** SET OF 4 CAGE NUTS M6 AND 4 CROSS RECESSED PAN HEAD SCREWS DIN7985 H M6x12 - STEEL ZINC PLATED INCLUDED IN PLASTIC BAG
- 03** COUPLER FIXINGS WITH 24 SELFTAPPING SCREWS, SURPLUS PACKED IN PLASTIC BAG
POZI PAN HEAD NR2 x 3/8" - DIN 7981 TYPE B (ST2,2 x 6,5MM - DIN 7981 F-H)
PART NUMBER 4-1201271-7
- 04** CABLE MANAGEMENT, CABLE GLANDS, SPLICE HOLDERS AND HOLE PLUGS
PACKED IN PLASTIC BAG
(SHOWN ON DRAWING IN SUGGESTED POSITION)
- 05** LASER LOGO AND LASER TEXT LABEL INCLUDED IN PLASTIC BAG

NOTE
 - Pigtails included not installed
 - Instruction Sheet 114NC-0018-3-07/05 included

1	1	1	-	M25 HOLE PLUG	14
1	1	1	-	M20 HOLE PLUG	13
2	2	2	-	SWELL LATCH	12
8	8	8	-	OFN SADDLE	11
2	2	2	-	CABLE MNGM. SPIDER	10
1	1	1	-	CABLE GLAND M25	9
1	1	1	-	CABLE GLAND M20	8
4	4	4	-	SPLICE HOLDER	7
-	6	12	-	BLANKING PLUG ST-TYPE	6
4	4	4	-	R.H. BRACKET	5
4	4	4	-	L.H. BRACKET	4
4	4	4	-	COVER	3
4	4	4	-	TRAY	2
12	6	-	0-5504640-1	COUPLING RECEPTACLE KIT	1
4--4	2--4	0--8			
QUANTITY		PART NUMBER		DESCRIPTION	ITEM
CUSTOMER DRAWING					part N° : 1206505

DRAWING STATUS: RELEASED		REVISION DESCRIPTION: - PN Coupler Changed		
DRAWING BY: H. BLEUS DATE: 28-FEB-03		DRAWING REVISION BY: R. VANDOREN DATE: 31-OCT-08		VOLUME OF MOULDED PART OR AREA OF UNFOLDED SHEET/METAL PART: mm³ / mm²
SCALE: 1000	DRAWING FORMAT: A1	DRAWING TITLE: F.O. 1U PANEL 12 SC DUPLEX MM (220mm)		
ISO-SYMBOL:	GENERAL TOLERANCE: -	DRAWING SHEET, REVISION NUMBER: D_0010587_01.AJ		
COMMSCOPE, INC.		REVISION: AJ		THE DRAWING AND INFORMATION SET FORTH HERE ON ARE THE PROPERTY OF COMMSCOPE, INC. AND ARE TO BE HELD IN TRUST AND CONFIDENCE. PUBLICATION, DUPLICATION, DISCLOSURE OR USE FOR ANY PURPOSE NOT EXPRESSLY AUTHORIZED IN WRITING BY COMMSCOPE IS PROHIBITED.