

TFAM85/19-34

ION®-B Series Medium Power Remote Unit for Cellular 850 and PCS 1900



OBSOLETE

This product was discontinued on: December 1, 2016

Product Classification

Product Type	Remote unit
Product Brand	ION®-B

General Specifications

Note	Detailed Product Specifications are available. Please contact your local CommScope representative.
Power Class	Medium

Dimension Drawing

TFAM85/19-34

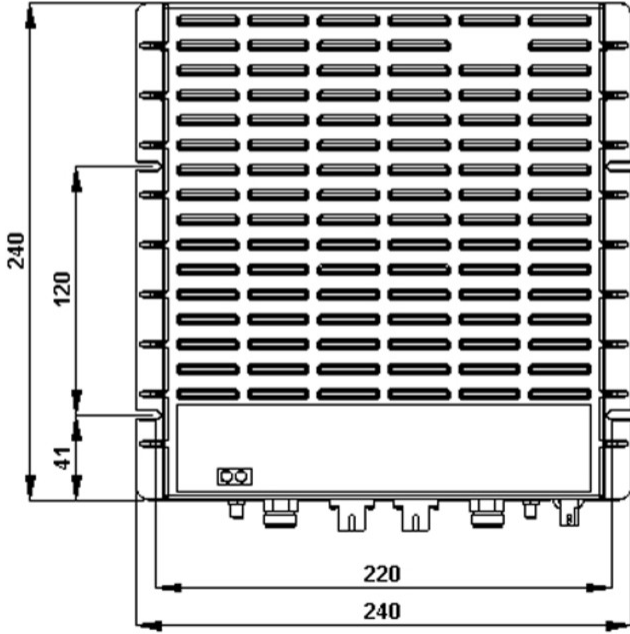
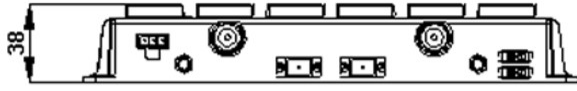

Electrical Specifications

Impedance	50 ohm
License Band	CEL 850 PCS 1900
Voltage Range	-60 to -36 Vdc

Electrical Specifications, Rx (Uplink)

Operating Frequency Band	1850 – 1910 MHz (PCS 1900) 824 – 849 MHz (CEL 850)
---------------------------------	--

Electrical Specifications, Tx (Downlink)

Operating Frequency Band	1930 – 1990 MHz (PCS 1900) 869 – 894 MHz (CEL 850)
---------------------------------	--

Regulatory Compliance/Certifications

TFAM85/19-34

Agency

CHINA-ROHS

ISO 9001:2015

ROHS

UK-ROHS

Classification

Above maximum concentration value

Designed, manufactured and/or distributed under this quality management system

Compliant/Exempted

Compliant/Exempted



Included Products

TPSN3/05-30 – Power Supply Adapter ION®-B Series Remote Units, 30 W

TPSN3/05-30

Power Supply Adapter ION®-B Series Remote Units, 30 W



Product Classification

Product Type

Power adapters

Product Brand

ION®-B

General Specifications

Note

Detailed Product Specifications are available. Please contact your local CommScope representative.

Dimension Drawing

TPSN3/05-30

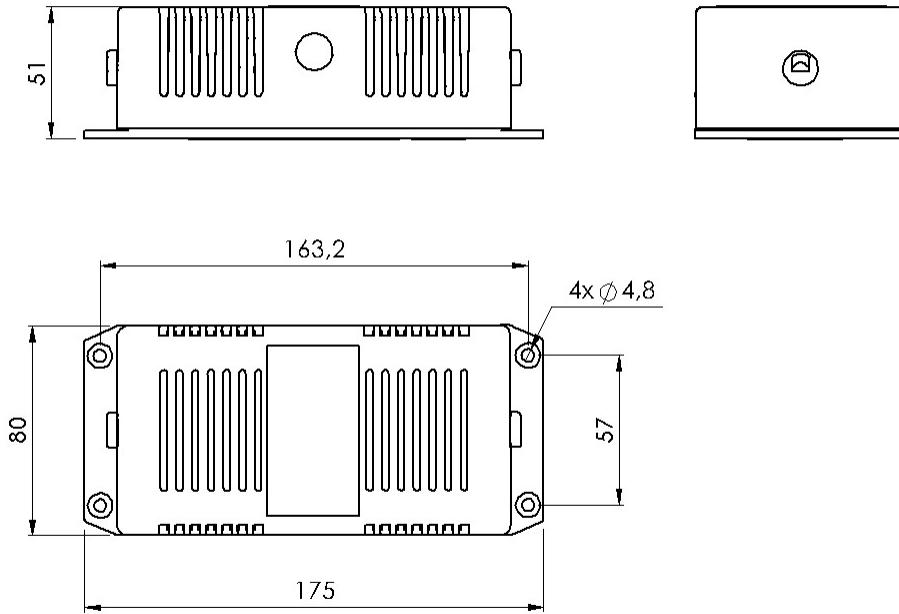

Electrical Specifications

Output Power, maximum

30 W

Regulatory Compliance/Certifications

Agency

Classification

CHINA-ROHS

Below maximum concentration value

ISO 9001:2015

Designed, manufactured and/or distributed under this quality management system

REACH-SVHC

Compliant as per SVHC revision on www.commscope.com/ProductCompliance

ROHS

Compliant

UK-ROHS

Compliant

